

AECOM  
 DOUGLAS BUSINESS CENTRE  
 CARRIGLINE ROAD  
 DOUGLAS  
 CORK  
 Tel: +353 (0)21 436 5006  
 www.aecom.com

1. THIS DRAWING IS TO BE READ IN CONJUNCTION WITH ALL OTHER RELEVANT ENGINEERING DRAWINGS. ANY DISCREPANCIES, ERRORS OR OMISSIONS TO BE BROUGHT TO THE ATTENTION OF THE EMPLOYER.
2. ALL DIMENSIONS TO BE CHECKED BY THE CONTRACTOR ON SITE PRIOR TO COMMENCEMENT OF WORKS.
3. EMPLOYER'S REPRESENTATIVE TO BE INFORMED BY THE CONTRACTOR OF ANY DISCREPANCIES PRIOR TO THE COMMENCEMENT OF WORKS ON SITE.
4. DIMENSIONS OF ALL BOUNDARIES AND ADJOINING ROADS TO BE CHECKED ON SITE PRIOR TO COMMENCEMENT OF WORKS.
5. DO NOT SCALE. ALL MEASUREMENTS AND COORDINATES TO BE CHECKED ON SITE.
6. EXISTING FENCE LINES ARE INDICATIVE AND ARE TO BE CONFIRMED ON SITE. EXISTING FENCING IS TO BE REVIEWED ON SITE AND REPLACED WHERE REQUIRED.
7. EMERGENCY ACCESS POINTS ARE TO BE CLOSED OFF WITH DEMOUNTABLE BOLLARDS. KEYS TO BE HANDED OVER TO THE OVERSEEING ORGANISATION.
8. eGREENWAY DRAINAGE IS TO BE OVER THE EDGE DRAINAGE
9. PROPOSED FENCELINE TO BE ERECTED IN ACCORDANCE WITH T11 STANDARD DETAIL CC-SCD-00303

I/R	DATE	DESCRIPTION
D	DEC 2023	ABP RFI UPDATE
C	MAY 2023	ABP RFI UPDATE
B	MAY 2020	ISSUED FOR INFORMATION
A	APRIL 2020	ISSUED FOR INFORMATION

60617025

PLAN AND PROFILE  
 VALLEYMOUNT  
 SHEET 5 OF 15

60617025\_SHT\_DD\_BLGWY\_145.5

ISO A1 594mm x 841mm  
 Approved: EDM  
 Checked: MC  
 Designer: CL  
 Project Management Initials:

File name: \\EU-AECOM\NET\COM\MEM\A\K\I\B\2\0\B\5\PR-4\47455-BLESSINGTON\_GREENWAY\900\_CAD\_GIS\910\_CAD20-SHEET\VALLEYMOUNT\60617025\_SHT\_BLGWY\_140\_VALLEYMOUNT\_PC\_PLAN AND PROFILE.DWG  
 Last saved by: MCGOVERNT4 Last Plotted: 2023-12-15

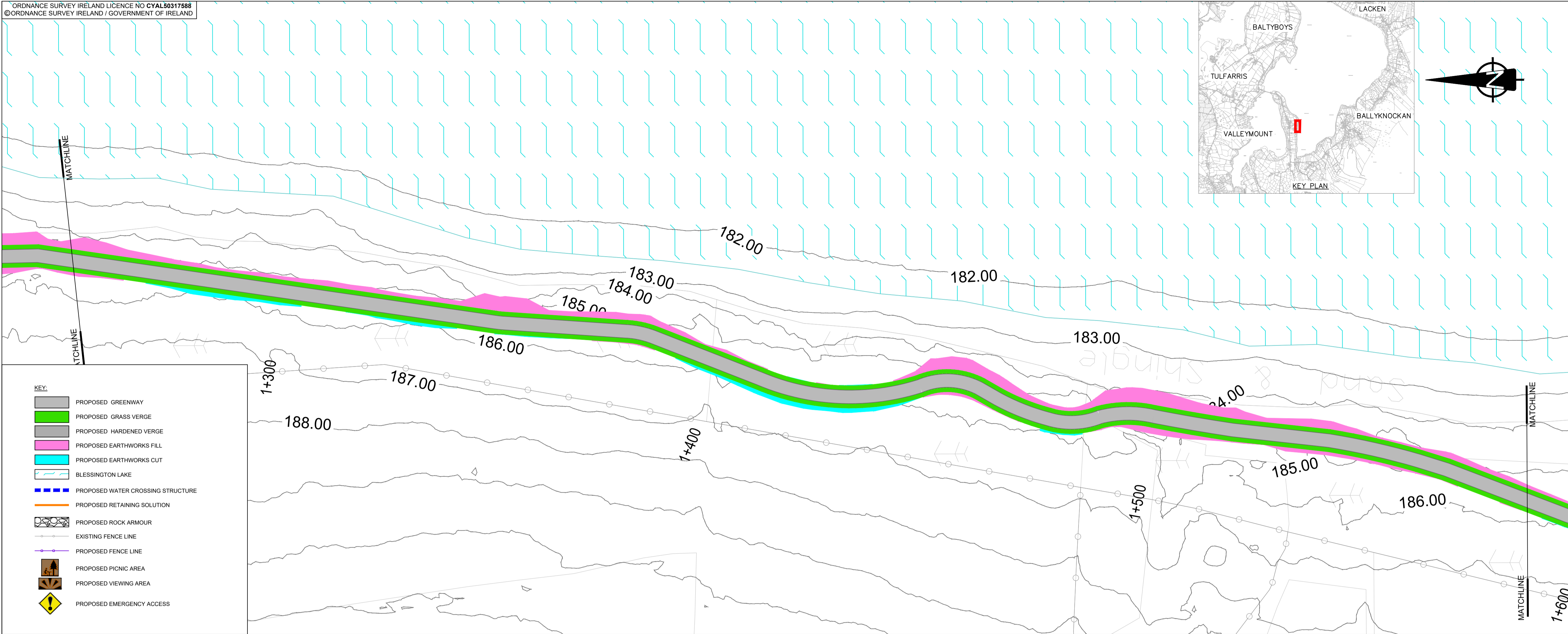

**PHASE 1 - CL LONGSECTION**  
 SCALE: H 1:1000, V 1:200

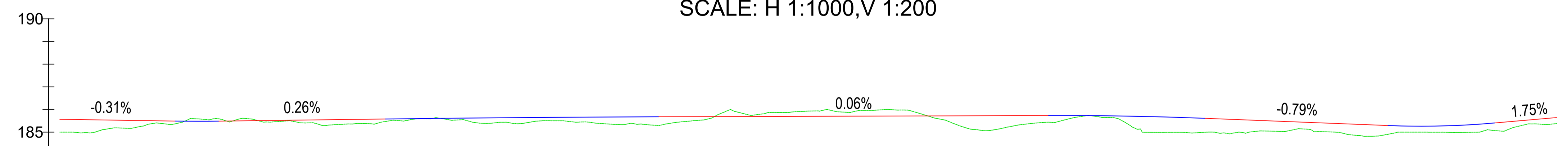

CHAINAGE	1250.000	1300.000	1350.000	1400.000	1450.000	1500.000	1550.000	1580.000			
EXISTING LEVELS	185.000	185.494	185.385	185.856	185.177	184.965	185.000	185.378			
PROPOSED LEVELS	185.568	185.524	185.640	185.689	185.721	185.627	185.263	185.643			
VERTICAL ALIGNMENT	G=-0.31% -1:318.7		L=9.618 K=16.8	G=0.26% 1:387.0		L=60.24 K=310.74	G=0.06% 1:1549.4	L=34.49 K=40.56	G=-0.79% -1:127.3	L=23.601 K=9.31	G=1.75% 1:57.2

This drawing has been prepared for the use of AECOM's client. It may not be used, modified, reproduced or relied upon by third parties, except as agreed by AECOM, or as required by law. AECOM accepts no responsibility, and denies any liability, whatsoever, to any party that uses or relies on this drawing without AECOM's express written consent. Do not scale this document. All measurements must be obtained from the stated dimensions.